

REVISION	02
DATE	24.01.22

## TECHNICAL DATA SHEET

**PRODUCT : SS FLANGE ANCHOR**

**REF NO. : SA 41**

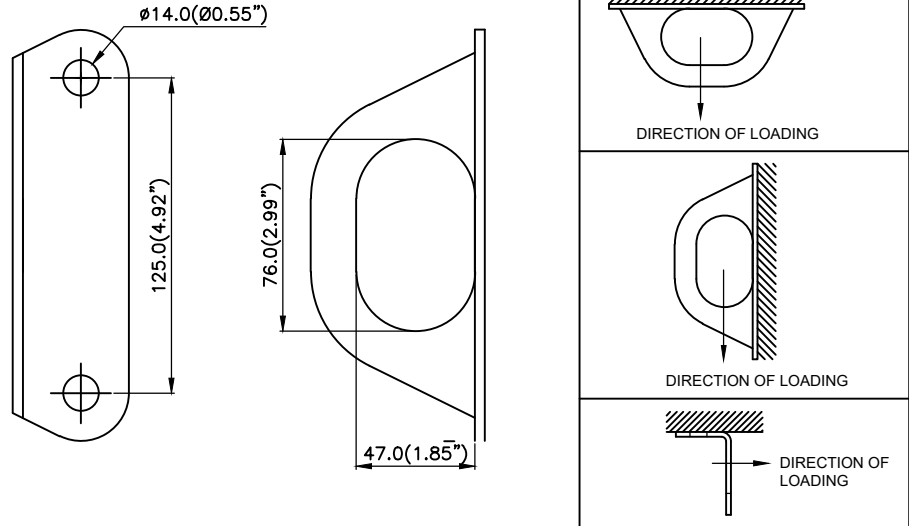

Conforms to EN795 : 2012 Type A &  
ANSI Z 359.18-2017 Type A.

01	DESIGN	<ul style="list-style-type: none"> <li>Stainless steel flange anchor is designed to be fixed on Walls, Ceilings, Roof tops or steel structures.</li> <li>It can be used to sustain the load impact in all three axis 'X' , 'Y' &amp; 'Z'</li> </ul>
02	MATERIAL	<ul style="list-style-type: none"> <li>Stainless Steel.</li> </ul>
03	FINISH	<ul style="list-style-type: none"> <li>Electropolished / E Coated.</li> </ul>
04	MINIMUM BREAKING STRENGTH	<ul style="list-style-type: none"> <li>X Axis : 23kN (5000 lbs)</li> <li>Y Axis : 23kN (5000 lbs)</li> <li>Z Axis : 23kN (5000 lbs)</li> </ul>
05	WEIGHT	<ul style="list-style-type: none"> <li>311.0 gms ±10 gms (0.68 lbs ± 0.022 lbs).</li> </ul>